

SUITE 101:
 NO CEILING INSTALLED
 EXISTING STOREFRONT GLASS:
 -SINGLE PANE
 -PREFINISHED WHITE ALUMINUM
 -9'-6"
 EXISTING ELECTRICAL:
 200 AMP MAIN PANEL; 42 CKT 208/120 3 PHASE
 EXISTING MECHANICAL SYSTEM:
 AC #1
 -CARRIER
 -MODEL # 50TQ006---501--
 -HEAT PUMP
 EXISTING PLUMBING:
 -RESTROOM (NON-COMPLIANT); ADA WATER
 CLOSET, WALL HUNG LAV
 -MISC PLUMBING FROM PREVIOUS TENANT

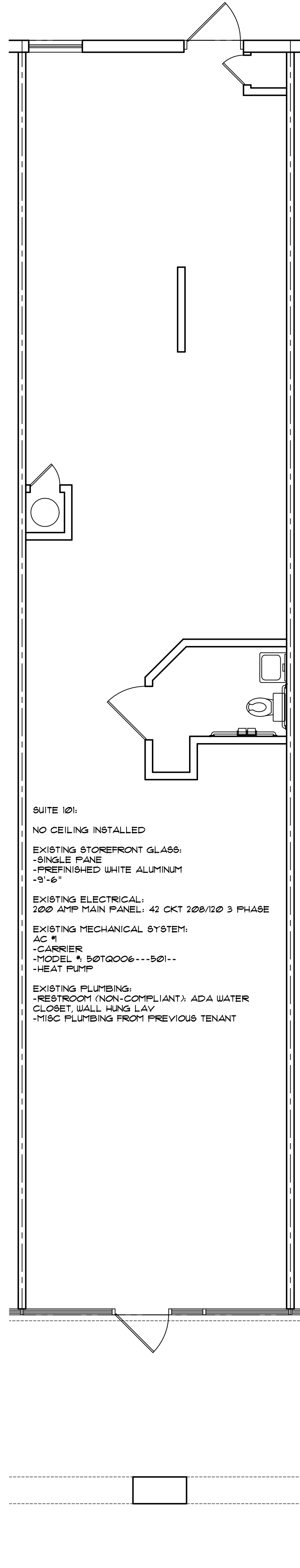

SUITE 101:
 NO CEILING INSTALLED
 EXISTING STOREFRONT GLASS:
 -SINGLE PANE
 -PREFINISHED WHITE ALUMINUM
 -9'-6"
 EXISTING ELECTRICAL:
 200 AMP MAIN PANEL; 42 CKT 208/120 3 PHASE
 EXISTING MECHANICAL SYSTEM:
 AC #1
 -CARRIER
 -MODEL # 50TQ006---501--
 -HEAT PUMP
 EXISTING PLUMBING:
 -RESTROOM (NON-COMPLIANT); ADA WATER
 CLOSET, WALL HUNG LAV
 -MISC PLUMBING FROM PREVIOUS TENANT

PIMA CROSSING
 SUITE: 8776 #101
 LOD PLAN
 AREA: 1072 SF

SCALE: 1/4" = 1'-0"

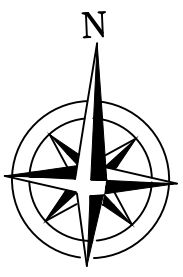

PIMA CROSSING
 SUITE: 8776 #101
 FLOOR PLAN
 AREA: 1072 SF

SCALE: 1/4" = 1'-0"

