

WEST THIRD STREET

SOUTH MILL AVENUE

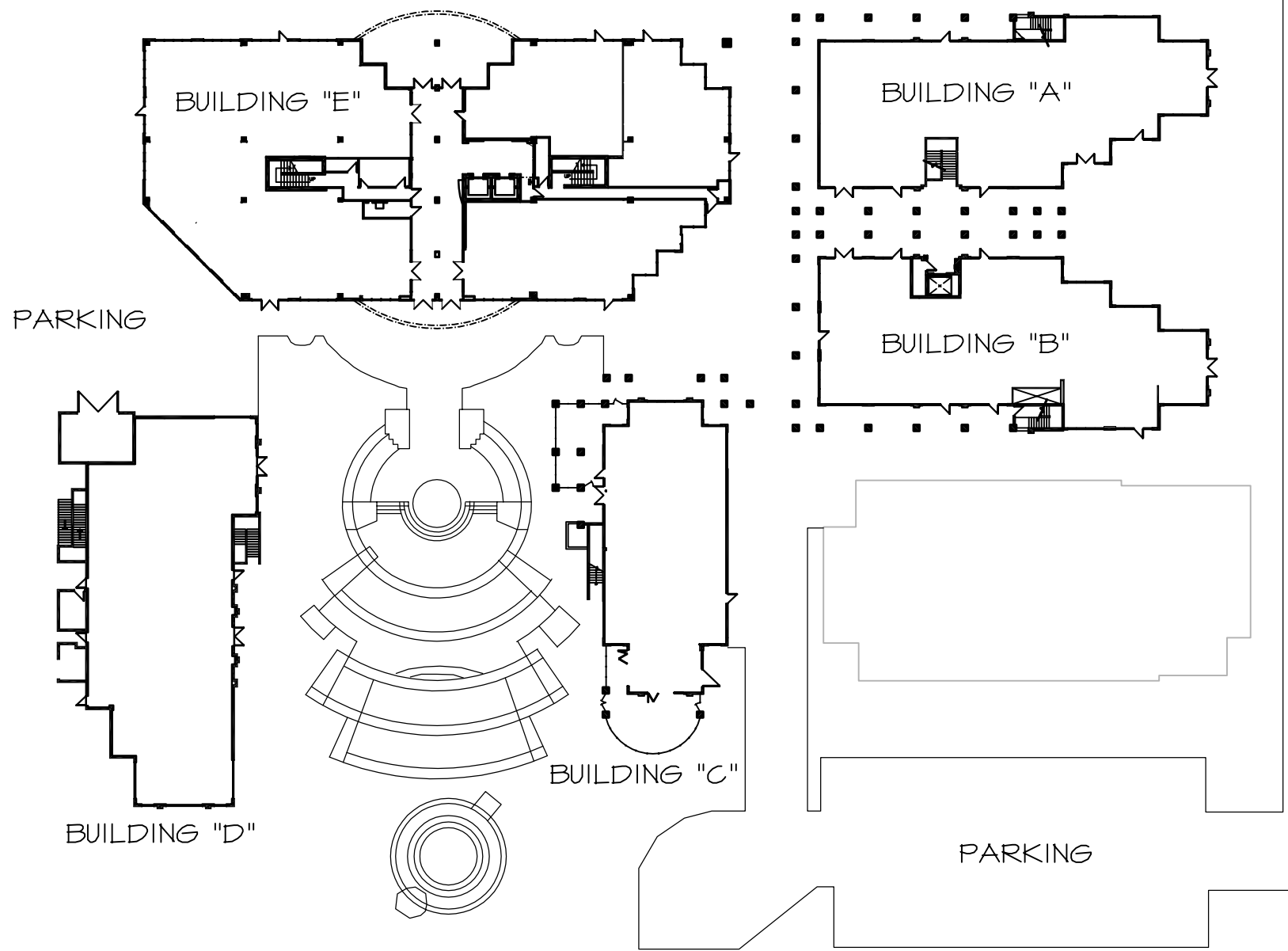

SITE PLAN
SCALE: 1/8" = 1'-0"



evolutiondesign
 interior architecture
 81 N. 2nd Street
 Suite 105
 Tempe, AZ 85281
 Telephone: 480-841-0280
 Fax: 480-841-0281

**SITE PLAN
 HAYDEN SQUARE COMPLEX
 W. THIRD STREET & SOUTH MILL AVE.
 TEMPE, ARIZONA**

REVISIONS

DESIGNED BY
 JKL
 DRAWN BY
 RT
 DATE
 11/10
 SCALE
 N.T.S.

PROJECT NUMBER
 100000000
 SHEET NAME
 SITE PLAN
 SP-1